

KWIKWAY®

Power Feed

(Kwik-Lathe PFA)

For the
On-The-Car
Rotor Lathe

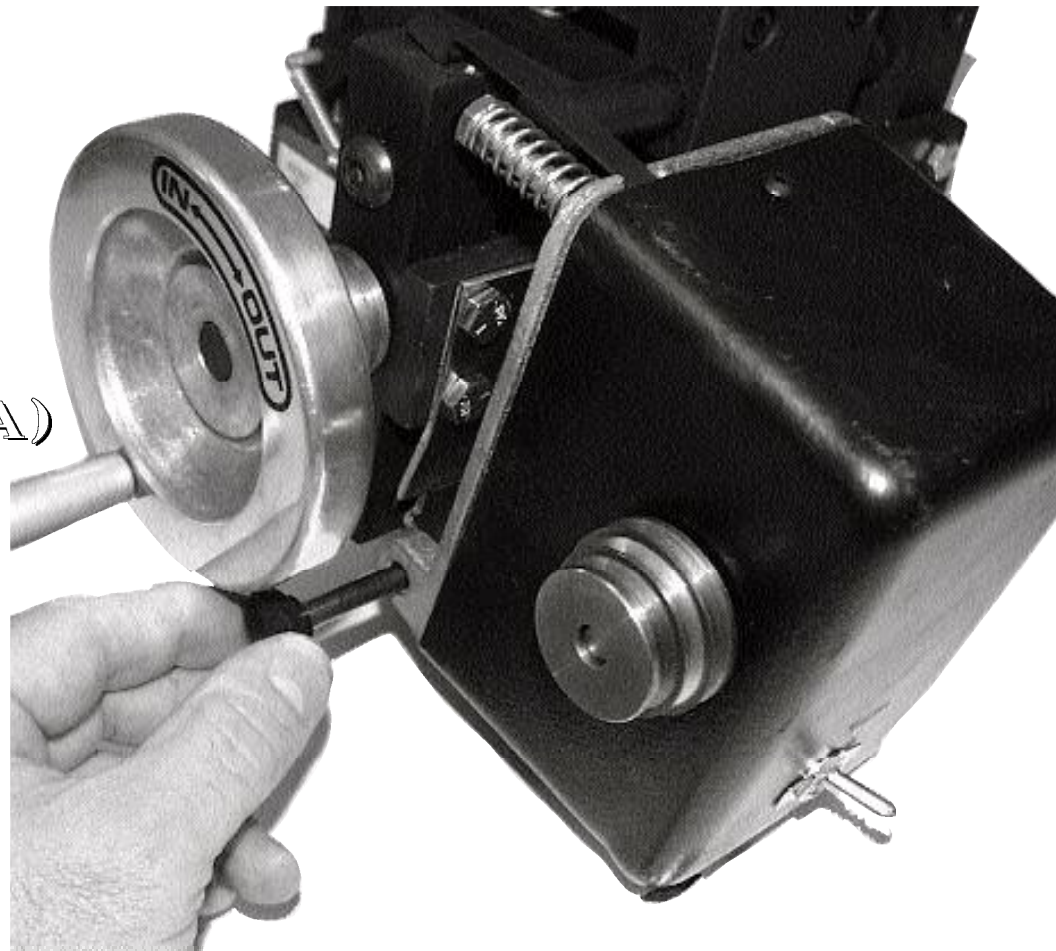

Instruction Manual and Parts List

KW Products Inc.
Copyright © 2003, All Rights Reserved

521 WARRANTY

Brake Lathes • Tire Changers • Wheel Balancers

KW Products Inc. (KWIK-WAY) provides a limited 521 Warranty on products when purchased in a new and unused condition to be free from defective material or workmanship from date of purchase as per the following:

Product Category	BENCH MODEL LATHES	ON-CAR-LATHES	PASSENGER CAR TIRE CHANGERS	WHEEL BALANCERS	TRUCK LATHES AND TIRE CHANGERS
5 Years	Spindle, spindle bearing and housing	Cast iron components, excluding guide rods	Transmission	Frame, welding construction	N/A
2 Years	All other mechanical parts	All other mechanical parts	Pedal controls	Shaft	N/A
1 Year	Electrical motors and labor	Electric motors and labor	Parts, electrics and labor	Parts, electrics and labor	Parts, electrics and labor

This warranty does not apply to a product that has been purchased in used condition, that has failed due to improper installation, repairs, service or that has sustained damage caused by accident, improper use or shipment.

Kwik-Way will repair and/or replace, free of charge (FOB factory) all such defective parts, only when returned to factory with shipping charges prepaid. This warranty does not cover parts and supplies consumed in normal operation of the machine.

Kwik-Way disclaims all other warranties, expressed or implied, as to the quality of any goods, including implied warranties of MERCHANTABILITY and FITNESS FOR PARTICULAR PURPOSES. UNDER NO CIRCUMSTANCES WHATSOEVER, SHALL KWIK-WAY BE LIABLE FOR ANY INCIDENTAL OR CONSEQUENTIAL DAMAGES, WHETHER BASED ON LOST GOODWILL, LOST RESALE PROFITS, WORK STOPPAGE, IMPAIRMENT OF OTHER GOODS OR ARISING OUT OF BREACH OF ANY EXPRESS OR IMPLIED WARRANTY, BREACH OF CONTRACT, NEGLIGENCE OR OTHERWISE, EXCEPT ONLY IN THE CASE OF PERSONAL INJURY WHERE APPLICABLE LAW REQUIRES SUCH LIABILITY. This limited warranty gives you specific legal rights and you may also have other rights which vary from state to state. This document contains the complete text of this warranty and may not be modified either orally or in writing.

Because of **KWIK-WAY's** constant program of product improvement, specifications are subject to change without notice.



Office Hours: 7:30 to 5:00 Central Time

KW Products Inc.

500 57th Street

Marion, Iowa 52302

Toll Free **1-800-553-5953**

Fax 319-377-9101

www.kwik-way.com

service@kwik-way.com

Receiving Shipment

Upon taking delivery of your machine, carefully inspect the assembly before removing the crating and packing materials.

If evidence of damage exists, contact the shipper and ***KW Products Inc.*** immediately. Although ***KW Products Inc.*** is not responsible for damage incurred during transit, you will be provided assistance in preparation and filing of any necessary claims.

CAREFULLY READ THIS MANUAL BEFORE ATTEMPTING TO SET-UP OR OPERATE THIS MACHINE.

Important Note:

Always have your serial number ready when communicating with ***KW Products Inc.*** regarding parts or service.

Keep this manual in a safe place.

Date

Received _____

Serial Number _____

(Serial Number location: Upper left corner at rear of unit)

TABLE OF CONTENTS

SAFETY INSTRUCTIONS

MOUNTING & SET-UP

PARTS

WIRING DIAGRAM

PAGE

2

4

6

8



A Tradition of Automotive Precision Since 1920

Toll Free **1-800-553-5953**

www.kwik-way.com

KW Products Inc.

500 57th Street

Marion, Iowa 52302

319-377-9421

Fax 319-377-9101

Email: service@kwik-way.com

SAFETY FIRST

This manual has been prepared for the owner and those responsible for the maintenance of this machine. It's purpose aside from proper maintenance and operations, is to promote safety through the use of accepted practice. **READ THE SAFETY AND OPERATING INSTRUCTIONS THOROUGHLY BEFORE OPERATING THE MACHINE.**

In order to obtain maximum life and efficiency from your machine, follow all the instructions in the operating manuals carefully.

The specifications put forth in this manual were in effect at the time of publication. However, owing to **KW Products'** policy of continuous improvement, changes to these specifications may be made at any time without obligation.

SAFETY INSTRUCTIONS

1. **Read, understand and follow** the safety and operating instructions found in this manual. Know the limitations and hazards associated with operating the machine.

NOTICE	▲ DANGER	▲ DANGER	▲ DANGER	▲ DANGER
				
Read the manual first Primero lea el Manual Zuerst Bedienungsanleitung lesen Lire le manuel avant	Do not operate without guard No manejar sin guardián Nur mit Schutzvorrichtung bedienen Ne pas faire marcher sans dispositif de sûreté	Electrically ground machine Máquina electricamente de sueld Elektrische Erdleitung Machiné terre électrique	Do not wear tie, confine loose clothing/hair No usar corbata, ropa/cabello suelto Vorsicht mit langem Haar/weite, lockere Kleidung Ne pas porter de cravate, vêtements ou cheveux pas restreints	Do not wear watches/jewelry No usar reloj de pulsera/joyería Uhren u. Ringe ablegen Ne pas porter de montres/bijouterie
DANGER	▲ CAUTION	▲ DANGER	▲ DANGER	▲ CAUTION
				
Wear safety glasses/shield Usar anteojos/protectores de seguridad Schutz-brille benutzen Porter lunettes de sé curité	Keep area dry and clean Mantener el area seca y limpia Arbeitsbereich trocken und sauber halten Maintenir ce zone sec et propre	Turn off before cleaning/adjusting Aparar antes de limpiar/ajustar Ausschalten bei Wartung Fermer avant de nettoyer/ajuster	Do not wear gloves No usar guantes Nicht mit Handschuhen bedienen Ne pas porter de gants	Tighten work piece securely Apretar pieza de trabajo con seguridad Werkstück fest spannen Serrer soûdement le pièce de travail

2. **Eye Safety:** Wear an approved safety face shield, goggles or safety glasses to protect eyes when operating the machine.
3. **Grounding the Machine:** Machines equipped with three prong grounding plugs are so equipped for your protection against shock hazards and should be plugged directly into a properly grounded three-prong receptacle in accordance with national electrical codes and local codes and ordinances. A grounding adapter may be used. If one is used, the green lead should be securely connected to a suitable electrical ground such as a ground wire system. Do not cut off the grounding prong or use an adapter with the grounding prong removed.
4. **Work Area:** Keep the floor around the machine clean and free of tools, tooling, stock scrap and other foreign material and oil, grease or coolant to minimize the danger of tripping or slipping. Kwik-Way recommends the use of anti-skid floor strips on the floor area where the operator

MOUNTING THE POWER FEED ON THE Kwik-Lathe ON-THE-CAR LATHE

1. Remove the two 1/4 x 3/4 hex screws (Item 5) from the Kwik-Lathe. Mount the support hinge (Item 1) as illustrated in Figure 1 to the Kwik-Lathe. Remove the pivot pin (Item 2), to release the support hinge on the power feed, for easier assembly.
2. After re-mounting the power feed mechanism to the support hinge, push the top portion of the power feed toward the Kwik-Lathe to compress the spring (Item 3) and lock the retaining clip (Item 4) over the edge of the lathe. (The belt (Item 6) can be installed and the Kwik-Lathe can be manually controlled, with the power feed in this locked position).
3. When using the power feed and Kwik-Lathe for on-the-car work, an extension cord with third wire ground must be used. (See Grounding Instructions-Page 5).
4. Refer to mounting instructions for using the Kwik-Lathe on-the-car lathe.
5. When the lathe has been properly positioned for the machining operation on the car, the power feed can be engaged by releasing the retaining clip (Item 4) from the bar on the lathe.
6. The motor stop and start switch is mounted on the power feed cover (Item 7).
7. The power feed will feed the tools from the inside, or small diameter of the disc, out only. All other positioning of the tools is by manual operation of the feed handwheel.
8. There are some on the car installations where there is not sufficient room to mount the power feed on the Lathe, and these discs must be machined with manual feed.

DO NOT USE POWER CORD AS A HANDLE

MOUNTING ILLUSTRATION

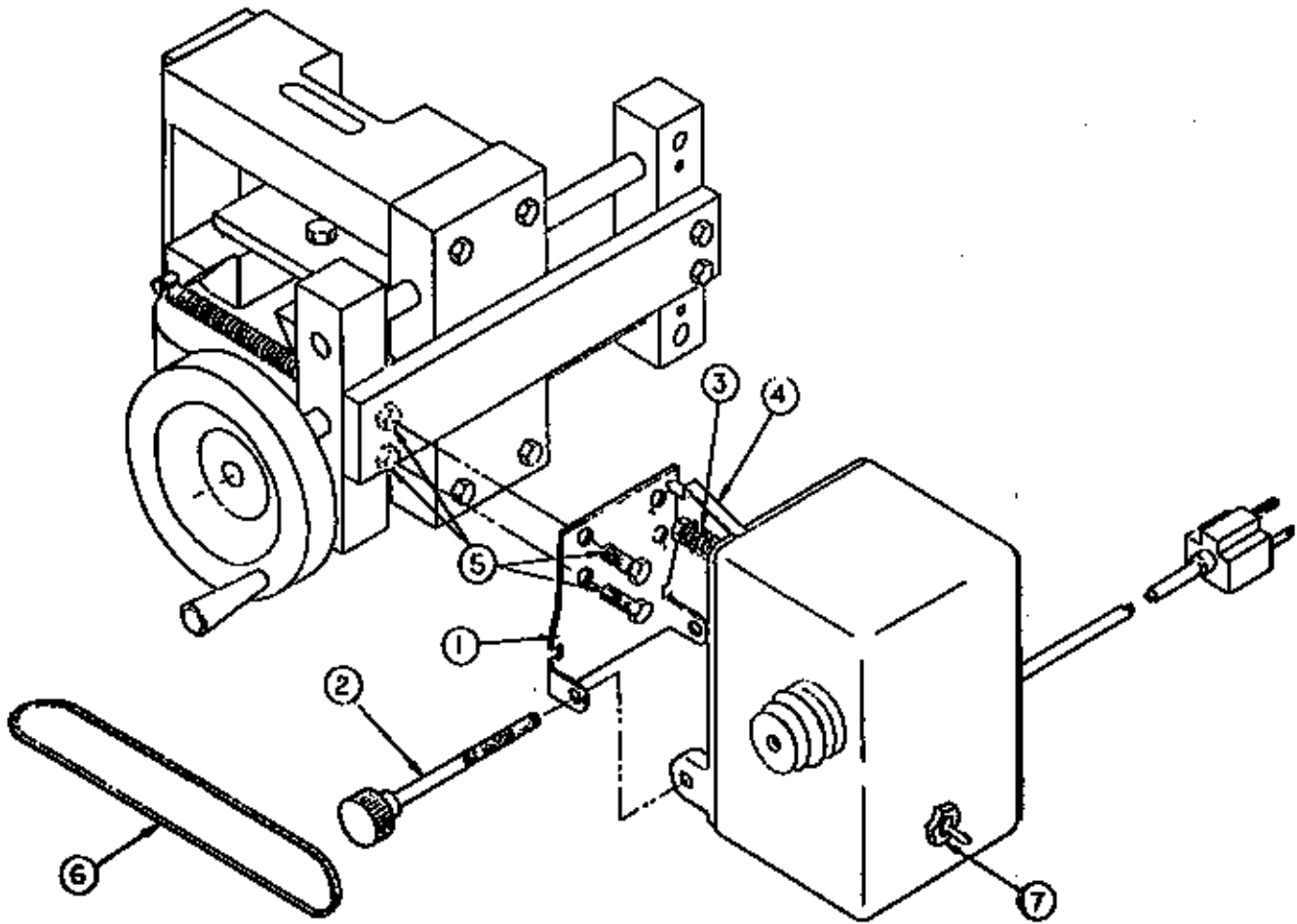

Figure 1



POWER FEED

PARTS LIST

REF NO.	PART NUMBER	DESCRIPTION	REQ'D
1	108-1201-18	Support Hinge	1
2	000-0166-91	1/4" - 20 x 3-1/2" Socket Head CapScrew	1
3	000-0761-39	Thumbscrew Cap 1/4"	1
4	108-1203-04	Bottom Cover	1
5	001-1938-72	Gearmotor (220/50/1)	1
6	000-0225-00	#10-32 x 1/2" Flat Head Machine Screw	2
7	108-1207-03	Retaining Clip	1
8	000-0342-74	6-32 x 5/16" Round Head Machine Screw	1
9	000-0100-06	1/4-20 x 2-3/4 Hex Head Cap Screw	1
10	000-1807-93	Compression Spring	1
12	000-1040-19	1/4-20 Hex Jam Nut Z.P	2
13	108-1205-09	Cover - Top	1
14	000-0205-75	10-32 x 1/4" Round Head Machine Screw	1
15	108-1208-00	Pulley	1
17	000-0471-00	#8-32 x 1/4 Socket Head Cup Point Set Screw.	1
18	000-0070-64	Polyflex Belt	1
19	000-1243-03	3302 Connector	1
20	000-1261-01	Cord Set 8'-6" 115V	1
21	000-1204-30	On-Off Switch Plate	1
22	000-1200-70	Switch-Toggle 230V	1
23	000-1202-19	Switch 115V	1
24	000-1261-28	Cordset 230V	1
25*	000-6600-16	Tag, Input	1
26	001-1938-68	Gearmotor (115/60/1)	1

* = NOT SHOWN

POWER FEED

COMPLETE VIEW

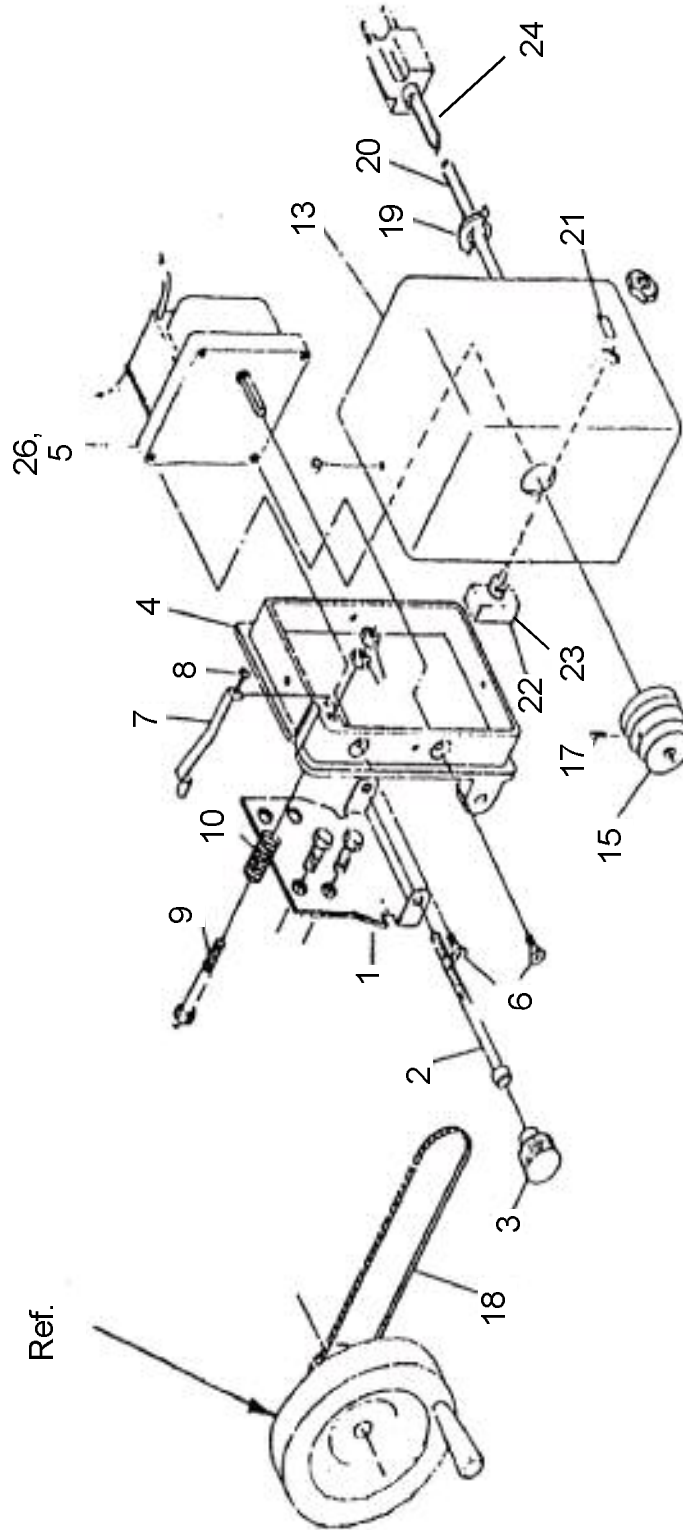

POWER FEED

WIRING DIAGRAM

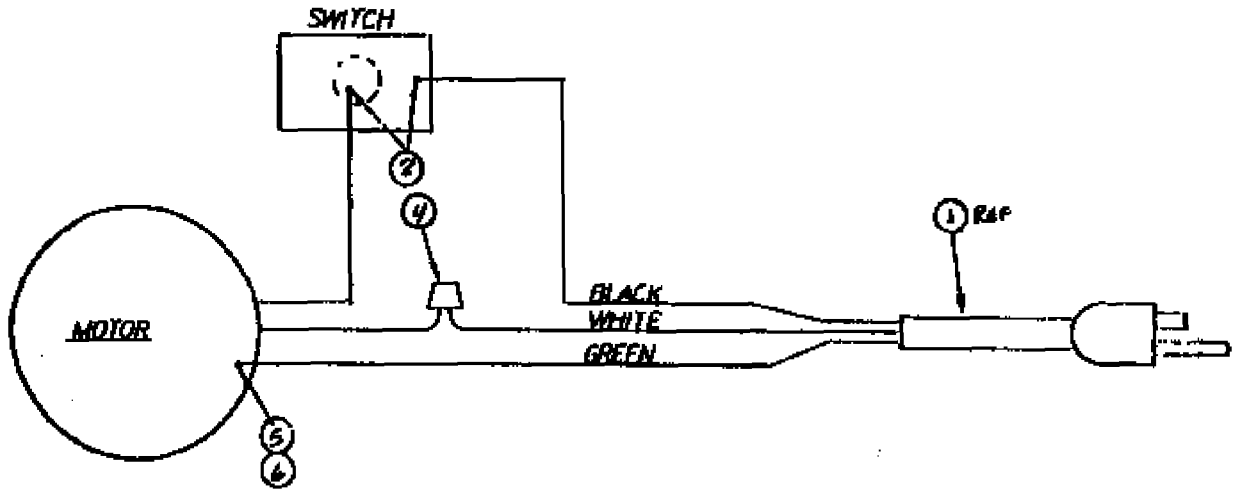

REF NO.	PART NUMBER	DESCRIPTION	REQ'D
1	000-1261-01	Wire Cord Set	1
2	000-1242-49	Female Flag Connector	2
4	000-1241-41	Wire Nut	1
5	000-1240-28	Hook Terminal	1
6	000-0205-75	1/4 Round Head Mach. Screw	1

GROUNDING INSTRUCTIONS

When installing a grounded machine in a business that does not have a three wire grounded receptacle, under no conditions is the grounding prong to be cut off or removed. It is the personal responsibility of the customer to contact a qualified electrician and have a properly grounded three-prong wall receptacle installed in accordance with the appropriate electrical code. Should a two-prong adapter plug be required temporarily, it is the personal responsibility of the customer to have it replaced with a properly grounded three-prong receptacle or a two-prong adapter properly grounded by a qualified electrician in accordance with the appropriate electrical code.

KWIKWAY®

KW Products Inc.

500 57th Street, Marion, IA 52302 USA

319-377-9421

319-377-9101 (FAX)

800-553-5953

www.kwik-way.com

service@kwik-way.com